

Move Lite Personal Mobility Chair

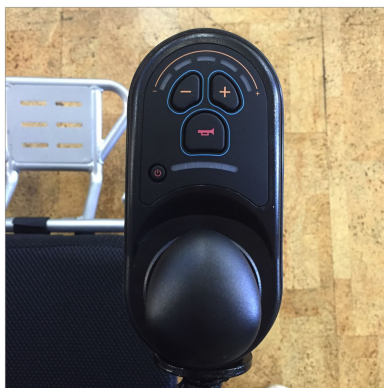

<u>Introduction</u>	3
<u>Disclaimer</u>	3
<u>Product Specifications</u>	4
<u>Safety, Operation & Setup</u>	5
<u>Introduction</u>	5
<u>Safety</u>	5
<u>Notice to Caretakers</u>	5
<u>Weight Limit</u>	5
<u>Tie Down System</u>	6
<u>Maintenance</u>	6
<u>Operation</u>	6
<u>Controller Settings</u>	6
<u>Power down when not in use</u>	6
<u>Reaching or Lean</u>	6
<u>Cornering Information</u>	7
<u>Obstacles</u>	7
<u>Curbs, Ramps, Slopes & Sidehills</u>	7
<u>Environment & Everyday Use</u>	8
<u>Controller</u>	8
<u>Braking System</u>	9
<u>Armrests</u>	9
<u>Free Wheel Mode</u>	9
<u>Setting up your Move Lite</u>	9

<u>Unboxing the Move Lite</u>	9
<u>Lock Latch</u>	12
<u>Free Wheel Mode</u>	13
<u>Installing the Controller</u>	14
<u>Batteries & Charging</u>	16
<u>Charging</u>	16
<u>Charging Tips & Notes</u>	18
<u>Operation and Installation</u>	19
<u>Controller</u>	22
<u>Controller & Driving Tips</u>	23
<u>Batteries</u>	24
<u>Seat Design & Materials</u>	24
<u>Fasteners</u>	24
<u>Change & Adjustments</u>	25
<u>Electromagnetic Interference (EMI)</u>	25
<u>Limited Warranty</u>	25

Introduction

Thank you and congratulations on the purchase of your new Move Lite Foldable Power Chair. It is important that you read through this manual before operating your chair - so, please take that time. You will find instructions and recommendations for easy operation of your Move Lite Power Chair. A Move Lite Customer Care representative can be contact at 323-522-5817.

Disclaimer

JDY Imports or Move Lite, its affiliates, and partners, cannot be held responsible for personal injury or property damage that results from the unsafe or the improper operation or maintenance of the Move Lite Power Chair, and/or other Move Lite products purchased.

From time to time, our product development and engineering department will make design recommendations for this product. So we reserve the right to make such changes when deemed necessary to improve on the design or to add value. As a result, there could be minor differences between the product that you have purchased and the photos, illustrations and instructions in this manual.

Product Specifications

Product Weight (With Battery)	59 lbs.
Maximum Weight Capacity	395 lbs.
Unfolded Size (L x W x H)	39" x 24" x 37"
Folded Size w/ cushion removed (L x W x H)	24" x 14" x 30.5"
Frame Material	Aluminum
Travel Distance	15.5 Miles
Maximum Speed (Adjustable)	3.7 MPH
Seat Size (L x W)	16" x 18.5"
Seat Height w/ cushion	19.5"
Armrest Height	27.5"
Turn Radius	31.5"
Maximum Speed	4 MPH
Ground clearance to foot rest	3.5"
Wheel Base (Front center to Rear center)	23"
Front Wheels (Diameter x Width)	7" x 1.75"
Rear Wheels	12" x 2.25"
Wheel Material	Solid, Polyurethane
Incline/Slope Capability	8 to 12 Degrees
Motor	(2) 250W Brushless Motors
Brakes	Electromagnetic
Battery	(2) Lithium Ion/24V 12aH
Battery Weight	6.6 lbs

Safety, Operation & Setup

Introduction

Please take the time and read through all the documentation here. It is important that the primary user and his or her companions understand all the safety instructions before operating this product.

Safety

- The Move Lite should be adjusted to fit your needs.
- Make sure to take your time to learn how the Move Lite works before you begin riding.
- Practice bending, reaching and transferring in and out of the Move Lite.
- Always be aware of your surroundings.
- Make it easy. If you're not sure the Move Lite and surpass an obstacle, try to find another way around.
- The Move Lite is designed for a single user. More than one users may result in personal injury to you and others.

Notice to Caretakers

Make sure that you pay careful attention to all warnings and follow all instructions in each section of this manual. (Be aware that warnings that apply to the rider also apply to you).

It is important that you pay close attention to all warnings in this section. If you fail to do so, you may fall, tip-over or lose control resulting in severe injury to you or others.

Weight Limit

- Never exceed a total weight of 395 lbs for rider plus items carried
- You should not attempt to perform weight training on your Move Lite if the total weight (rider plus additional weights) exceeds 395 lbs.
- Exceeding the weight limit is likely to damage the seat, frame, or fasteners and may cause severe injury to you or others
- Exceeding the weight limit will void the warranty

Tie Down System

The Move Lite is not approved to be used with any tie down system, generally used to transport a seated user and power chair in a motor vehicle.

- Never sit in the Move Lite while in a moving vehicle. In an accident or sudden stop you may be thrown from the Power Chair.
- Never transport the Move Lite in the front seat of a vehicle. It may shift and interfere with the driver.
- Always secure the Move Lite so that it cannot roll or shift.

Maintenance

To maintain performance, we recommend you take the Move Lite two to three times per year. Check the follow areas.

- Frame: Loose screws and tighten as necessary
- Wheels: make sure they rotate easily. Significant resistance may require new bearings.
- Armrests: looks for excessive wear
- Work: Replacement parts and more major maintenance issues should be done by professional. We recommend you do not do this work on your own.

Operation

Controller Settings

Make sure to get familiar with the controller settings and touch sensitivity of the joystick. The joystick controls speed, braking, and direction while you are travelling.

Power down when not in use

Always power-down your Move Lite when you are parked - even for a short moment. This will prevent:

- Accidental movement from contact with the joystick
- Unintended brake release or movement from EMI sources

Make sure that persons around you area aware of the joystick, unintended contact can cause movement and injury to unsuspecting bystanders.

Reaching or Lean

Take special care when reaching or leaning out from the Move Lite. Reaching or leaning can affect your center of balance, and if done improperly can cause a fall or tip-over. **When in**

doubt, ask for help or use a device to extend your reach. To reduce the risk of injury and/or damage to the Move Lite:

- Never reach or lean if you must shift your weight sideways or rise up off the seat
- Never reach or lean if you must move forward in your seat to do so
- Never reach with both hands (you may not be able to catch yourself to prevent a fall if you lose your balance)
- Never try to pick up an object from the floor by reaching down between your knees

Reaching Tips:

- Move yourself as close as you can to the object you wish to reach
- Turn off all power to the Move Lite before reaching
- Firmly grasp an armrest with one hand. This will help to prevent a fall if the Move Lite tips

Cornering Information

Always slow down while moving through a corner. Tipping over is a major concern while moving through a corner.

Cornering Tips:

- Take the corner slowly. High speed will increase the possibility of tipping
- Keep your eyes open for objects that may be obstructed by the corner
- Move through the corner a gentle radius as opposed to making a sharp turn

Obstacles

Obstacles come in many shapes and sizes, they include: door thresholds, ramps, potholes, curbs, glass, broken pavement and more. It's important to take care and avoid these obstacles as you can damage your Move Lite. Further, these obstacles could cause you a fall, tip-over or loss of control.

Curbs, Ramps, Slopes & Side Hills

The terrain has an effect on you and your power chair. Any sort of slope will change your center of balance. Always use your best judgement and if ever in doubt, have someone help you.

- Steep slopes pose a danger The ADA suggests ramps should offer 12 inches of run for every 1 inch in rise
- Wet or slippery surfaces - such as when ice, snow, water or oil - can cause a loss of traction which could result in a fall or tip-over
- A change in grade on a slope (or a lip, bump or depression). These may cause a fall or tip-over

- A drop-off at the bottom of a slope of as little as 3/4 inch can stop a front caster and cause the Move Lite to tip forward
- Be mindful of any side hills as tipping is an issue
- Your Move Lite is not designed to drive up or down a curb or step more than 1/2 inch high
 - To prevent a fall or tip-over, use ramps or have someone help you
 - If you must climb or descend a curb/step alone, please do so with extreme care. Go as straight up or straight down as you can. Never turn or climb or descend at an angle as a fall or tip-over is likely. Proceed slowly, at a steady speed.
- Stairs: Never use your Move Lite to go up or down stairs, even with an attendant. Doing so is likely to cause a fall or tip-over
- Escalators: Never take your Move Lite on an escalator, even with an attendant. Doing so is likely to cause a fall or tip-over.

Environment & Everyday Use

Your Move Lite is not designed for use in rain, snow, or icy conditions.

- Contact with water or excessive moisture can cause an electrical malfunction. The frame, motors and other Move Lite parts are not waterproof and can rust or corrode from the inside. To avoid issues, we suggest:
 - Minimize exposure to a rain or wet conditions
 - Never take your Move Lite into a shower, tub, pool or sauna.
 - Do not use your Move Lite in fresh or salt water (such as at the edge of a stream, lake, or ocean)
 - Make sure shroud cover and deck lid are secure
 - Make sure all electrical connections are secure. Dry the Move Lite as soon as you can if it gets wet, or if you use water to clean it
 - Make sure the battery area is kept dry
- Proceed slowly and use extra care if you must operate your Move Lite on a wet or slick surface
 - Do so only if you are sure it is safe
 - Stop if one or both main wheels lose traction
 - Never operate your Move Lite on a slope or ramp if there is snow, ice, water or oil film present. When in doubt, have someone help
 - When not in use, keep your Move Lite in a clean, dry place

Controller

The controller includes: speed control buttons, speed indicator lights, horn, and joystick. The controller receives a signal from the joystick and transfers those signals to the motor and brakes. Please take care to limit any exposure to moisture, as this may cause damage.

Braking System

The Move Lite is equipped with electromagnetic regenerative brakes. This means that the Move Lite will stop when the joystick is back at the default position (center/stop position).

Armrests

The Move Lite armrests are designed to flip up. Never lift the Move Lite by its armrests.

Free Wheel Mode

Free wheel mode releases the wheel from the motor assembly. Once in free wheel mode, a companion can easily push the Move Lite. To engage free wheel mode, push up on the two red levers - one next to each wheel. See Free Wheel Mode below, in the 'Setting up your Move Lite' section for pictures.

IMPORTANT: The red levers, by each wheel, should be in the down position for the Move Lite to operate under power.

Setting up your Move Lite

Unboxing the Move Lite

Given the size and weight of box, we recommend two people work on unboxing this item.

- #1. Open the top of the box.
- #2. Carefully tip the box over on it's side.



#3. Carefully remove the protective packing material and remove all the contents of the box.



With the box open, you should have the following items.

#4. Main unit which includes the seat and motor assembly

#5. Controller

#6. Batteries*

*Note: Most Move Lites ship with the batteries installed. However, some Move Lites will ship in two boxes: main unit/controller (4 & 5) and batteries (6).

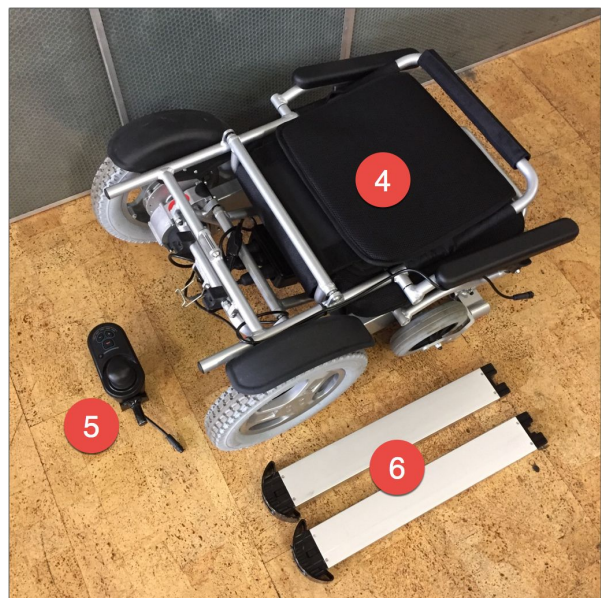

#7. Grab the padding as indicated and pull straight up.



#7. Here's an image of the Move Lite midway through opening. It's super easy.



#8. The Move Lite is open and ready for the controller, lock latch and, if necessary, batteries.



The following items are found in the pouch under the Move Lite's seat.

#9. Removable seat belt

#10. Multi-sized wrench

#11. Allen wrench

NOTE: We include these tools (#10 & #11) in case you need to tighten or repair your Move Lite. It's important to check connections periodically.

#12. Charger connector. This allows you to charge both batteries at the same time, just connect to charging under joystick. See our Batteries and Charging section below.

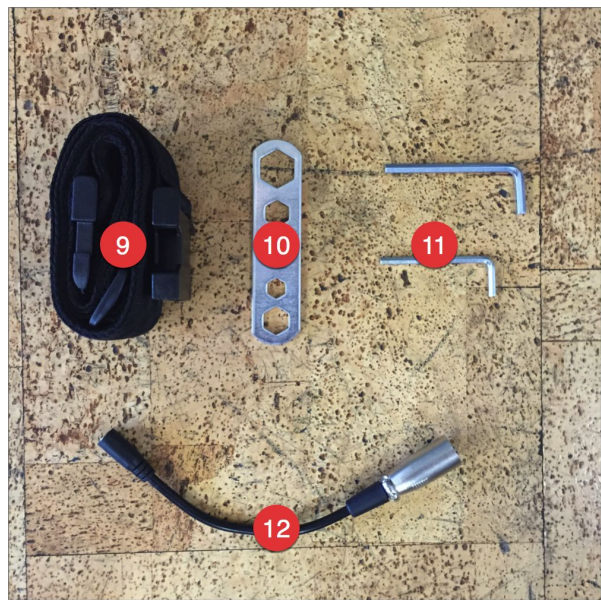

Lock Latch

Below you'll see the 'lock latch' connector, which is located under the seat; it's made up of two parts: (1) clip and (2) lever. Please use caution when closing the Move Lite, as the lock latch could get caught in the wrong position and break. Push the lock latch flat and out of the way.

Here the lock latch in the open position.

#1. The clip in the open position.

#2. Lever

To open, lift up on the lever.

You will need the lock latch open to fold the Move Lite.

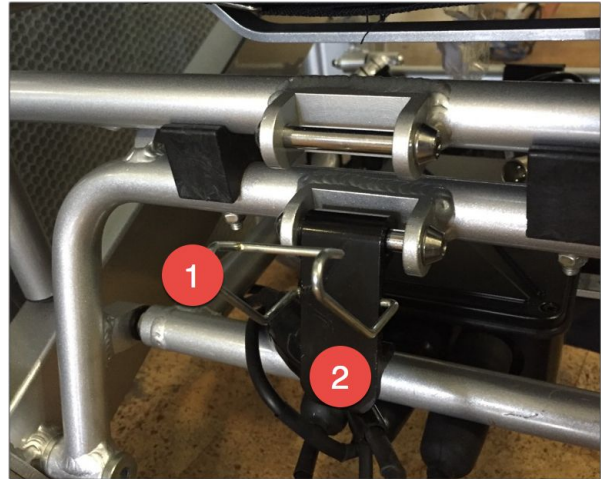

Here the Lock Latch closed.

#1. The clip in the closed.

#2. Lever

To close, position the clip over the small bar then push the lever down

Important: Only operate the Move Lite while lock latch is closed.

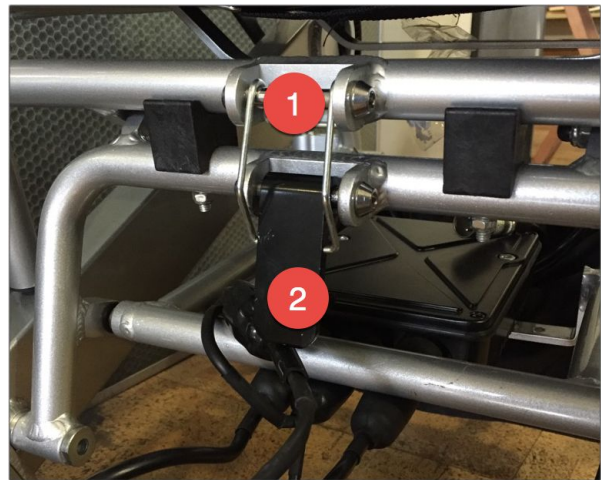

Free Wheel Mode

#1. Left free wheel toggle

#2. Right free wheel toggle

Push up to engage free wheel mode, use this setting to make it easier for a companion to push.

Push down to disengage free wheel mode, use this setting to drive the Move Lite.

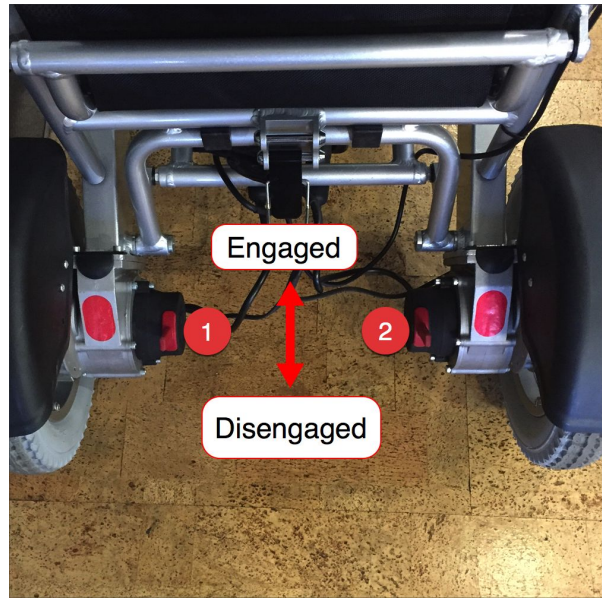

Installing the Controller

The main unit comes ready to receive the controller for a right-handed user. With a little rearranging, the Move Lite can be setup for a left-handed user as well.

#1. From the factory setup for right handed users.

#2. Available option for left handed setup.



Slide the controller into the open slot as shown.



#3. Tighten the knob to secure the controller in place.

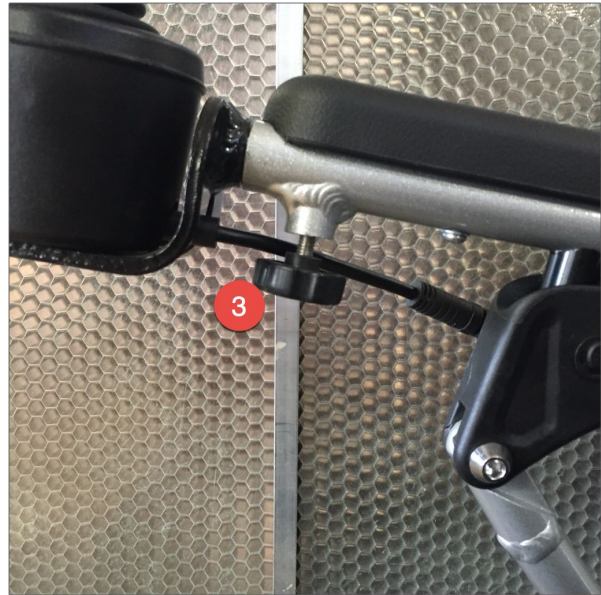

Connect the two ends of the of the wires - #4 and #5 - together. Once connected, secure the two wires by tighten the with the plastic coupling ring on #4.

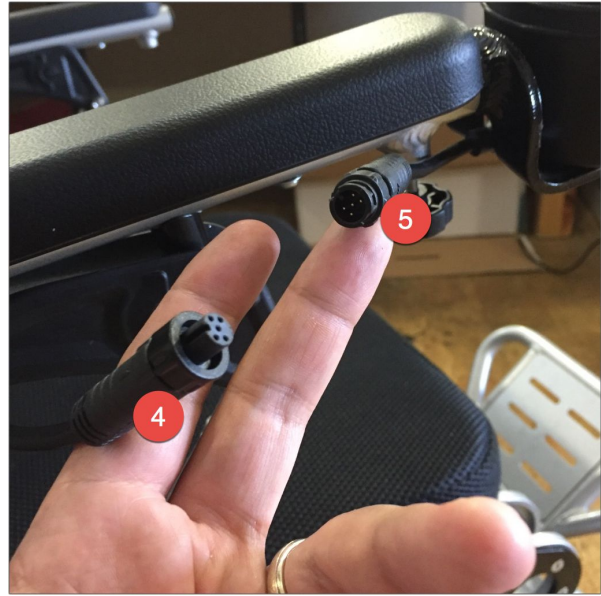

Here is a view of the connected controller.
#6. Coupling ring.

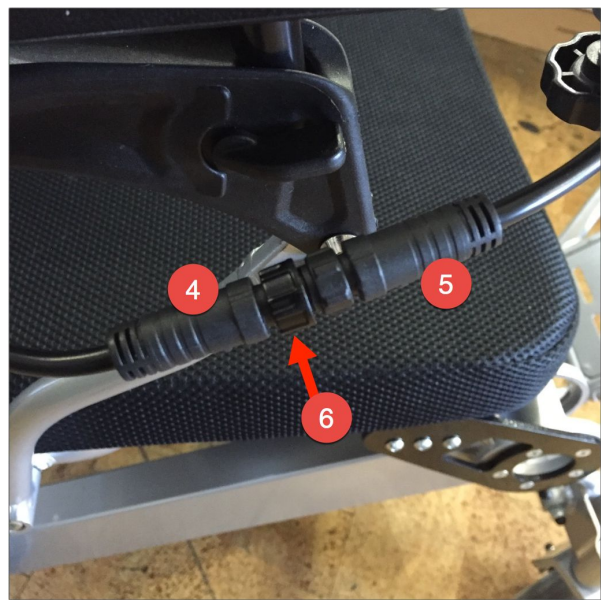

Batteries & Charging

Charging

The cord to charge the batteries comes in three parts.

#1. Wire which connects the electric outlet into the power supply brick

#2. Power supply brick

#3. Plug adapter

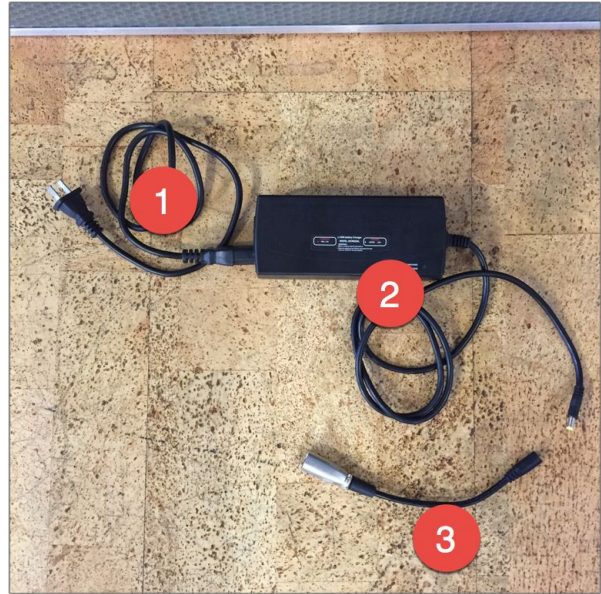

Preferred Charging Method

Attach all three cords together (#1, #2 & #3), and insert into #4.

This method allows you to charge both batteries at the same time.



Secondary charging method

Attached the first two parts of the cord (#1 and #2), then insert into #5.

Here you'll need to charge each battery separately.

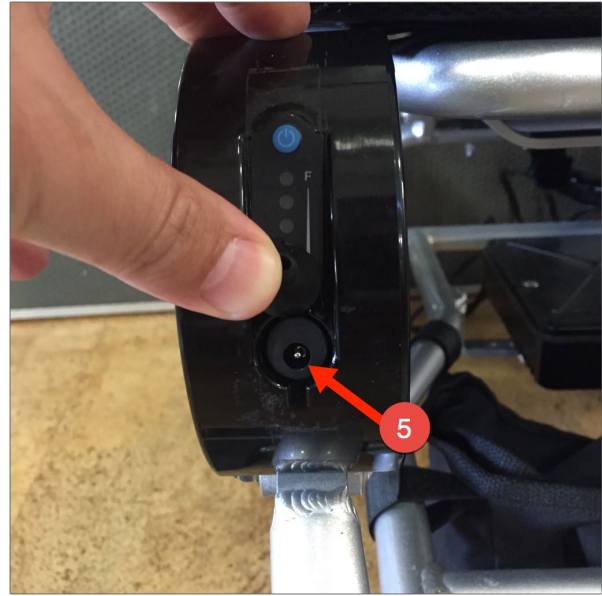

Charging Tips & Notes

- The Move Lite comes with two (2) 24V 12 Ah lithium ion batteries. They are (generally) pre-installed, partially charged and connected.
- Initial Charge: close to home, ride the Move Lite until it loses complete charge. Then charge the batteries for 8 hours. Using this method will maximize the overall life-cycle of the batteries.
- Turn the main unit's power off while charging.
- Do not leave children unsupervised near the Move Lite while it is charging
- Do not attempt to open the battery housing
- Red means the power is on and the unit is charging. Green means the unit is fully charged.
- When the battery is fully charged, remove the cable. Then take out the DC charging connector and AC input power socket.
- The average time taken to re-charge workable batteries will vary from 2 to 8 hours depending on the level of usage.
- Do not charge more than 6 hours to 8 hours.
- If you do not operate the Move Lite for two months, we recommend that you charge the battery for 6-8 hours before use.
- Over Current Protection: this will shut off the current thus shutting the motor down to ensure that the motor and battery do not experience any damage.
- The lifecycle of a lithium battery is measured in "Charge Cycles", and will charge for around 500 charge cycles.

- If you use the Move Lite daily, check the battery light indicator to see how much charge you have left. The Move Lite is equipped with two (2) lithium batteries and will go up to ~7 miles per battery, for a total of ~15 mile.
- Do not attempt to charge your battery if the Move Lite and battery have been frozen
- Do not use any third-party battery chargers unless certified by our company.
- Do a periodic check of the battery casing for damage and corrosion to the Red (Positive) and Black (Negative) battery connectors.
- If for some unexpected reason the battery gets damaged, make sure you do not touch it without the proper gloves.
- If the battery needs to be disposed of, locate the nearest “Hazardous Materials” disposal facility, and call them for instructions. In many cases the local city or municipality will have a program for “Hazardous Materials” disposal.
- Maximize operating time per charge is affected by:
 - Terrain: avoid hills and uneven or soft surfaces
 - Limit total weight
 - Fully charge your battery prior to your trip
 - Try to maintain a constant speed when possible
 - Avoid intermittent driving when possible
- Storing your Move Lite Battery
 - Fully charged before storing the unit
 - Remove the battery
 - Store the battery in a dry and warm place
 - Avoid temperature variation
- Do not attempt to charge your battery if it is frozen from extreme weather conditions

Operation and Installation

Your Move Lite comes with two batteries, both are required for operation.

Several things to note:

- Batteries may be installed upon delivery or they may arrive in a separate box.
- Replacement batteries are available. Please call for more details.

#1. Power check button. Hold down to check the amount of power is available.

#2. Power check read-out. Lights correspond to how much power is available in these batteries.

#3. Charging input.

Note: You can charge your Move Lite here. Also, you can both batteries via a connector under the controller.

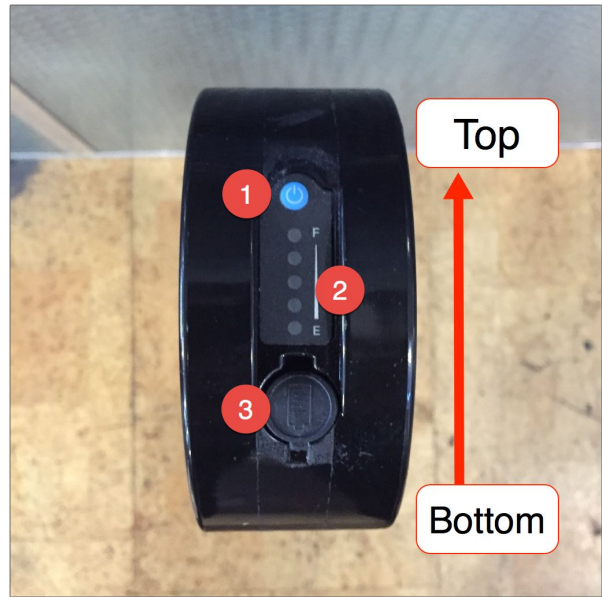

The Move Lite requires batteries on both sides.

Follow the image to match up the correct battery, you can the +/- on the back of the battery.

Note, the Move Lite battery compartment is only able to accept its corresponding battery. You will feel the battery slide all way in, if correct.



Here's a view of the bottom of the battery.
Molded into the plastic is the +/- sign.

Again, make sure to gently insert the battery.
It should slide easily into place.



Smoothly insert the batteries as shown.



To remove the batteries, pull out evenly while depressing the plastic clasp on each side.



Controller

- #1. Power Button - powers on/off chair
- #2. Horn
- #3. Speed Control Buttons - two buttons (plus & minus) allow the user to control max speed
- #4. Speed Indication Lights - five lights indication relative max speed
- #5. Battery Power Indication Lights - shows user how much power is available
- #6. Joystick - controls speed and direction of the chair



Controller & Driving Tips

- Take some time in a safe/controlled environment to learn operation
- Slow down to turn. Slower speeds will help you avoid any potential tilting/tipping of the Move Lite
- Speed control buttons (#3) allows you to adjust the maximum speed
- Be sure to adjust the speed depending on your environment
- To slow down, slowly bring the joystick back toward the initial position
- To stop, just bring the joystick back to the initial position
- Getting into the Move Lite
 - Before sitting, make sure the Move Lite is **powered off**, this will ensure the Move Lite will not move upon touching the joystick
 - Make sure the foot rest is down
 - Once onboard, make sure your feet are safely on the footrest
- Use your best judgement while driving
 - Be alert to the danger of motor vehicles on roads or in parking lots
 - At night, or when it is hard to see, use reflective tape on your MoveLite
- The Move Lite is designed for use on firm, even surfaces such as concrete, asphalt and indoor flooring
- Do not operate the Move Lite in sand, loose soil or over rough terrain. Doing so may damage wheels, bearings, axles or motors, or loosen fasteners

- Use extra care when you drive the Move Lite in reverse. You may lose control or fall if one of the rear wheels hits an object.
 - Operate the Move Lite slowly and at an even speed.
 - Stop often and check to make sure your path is clear of obstacles.
- Getting Off Your Move Lite
 - Make sure to bring the Move Lite to a complete stop
 - Power down the unit. This way you can avoid accidentally touching the joystick, thus causing the Move Lite to unexpectedly move while you are exiting
 - Raise the armrest so that you can conveniently exit the unit.
 - Carefully and safely get out of the seat.
- Make sure that electronic components such as the control panel, battery charger, and other electronic controlled components avoid moisture. If these components come into contact with moisture, dry before use.

Batteries

- Only use batteries approved and supplied by our company. Our batteries are special lithium batteries designed specifically for the use with the Move Lite.
- You must charge the battery for 6 to 8 hours before attempting to operate your Move Lite for the first time. Failure to do so will result in damage to the battery.
- Read all battery instructions before attempting to change or charge batteries.
- To remove the batteries, pull out evenly while depressing the plastic clasp on each side (under the battery's face). See page 22.

NOTE: Do not use any parts or components unless they have been authorized in writing by a representative of our company.

Seat Design & Materials

- We have used durable synthetic nylon mesh materials
- The Move Lite seat is designed for comfort, not specifically for pressure relief
- If you suffer from pressure sores, or if you are at risk that they will occur, please consult your doctor

Fasteners

Many of the screws, bolts and nuts on the Move Lite are special high-strength fasteners. Replacing these fasteners with non-approved parts may cause your Move Lite to result in faulty operation and may cause harm to you or other people, therefore:

1. Only use fasteners provided our company

2. If fasteners become loose, tighten them as soon as you can
3. Over or under-tightened fasteners may fail or cause damage to the Move Lite parts

Change & Adjustments

Never use non-Move Lite parts or make changes to your Move Lite unless authorized in writing by a representative from our company. Doing so will void the Warranty and may create a safety hazard.

Before each use of the Move Lite :

- Make sure the Move Lite is operating smoothly
- Check for noise, vibration, or a change in ease of use.
- If you detect a problem, make sure to fix the problem and/or make the proper adjustments.
- Deferring repair or adjustment could increase the risk for injury. Our customer care representatives can help you find and correct the problem.

Electromagnetic Interference (EMI)

Powered vehicle may be susceptible to electromagnetic interference (EMI), which is interfering electromagnetic energy (EM) emitted from sources such as radio stations, TV stations, amateur radio (HAM) transmitters, two-way radios, and cellular phones. The interference (from radio wave sources) can cause the powered vehicle to release its brakes, move by itself, or move in unintended directions.

Limited Warranty

The Move Lite comes with a limited warranty and the following coverage:

- **Frame:** JYD Imports warrants the frame of its mobility chair under normal use for a period of 1 Year (12 months). JYD Imports will at its sole discretion, repair, replace, any warrantable frame that fails within the warranty period.
- **Wearable Parts:** 6 months motor, transaxle, brake assembly, & electrical components: JYD Imports warrants the Motor/Transaxle/Brake and Electronics of the mobility chair, under normal use for a period of 1 Year (12 months). JYD Imports will at its sole discretion, repair or replace any warrantable Motor/Transaxle/Brake and Electronics components that fails within the warranty period.
- **3 months lithium batteries (purchased with units):** JYD Imports warrants the lithium batteries of the mobility chair, under normal use for the period of 3 months. JYD Imports will at its sole discretion, repair or replace any warrantable lithium battery that fails within the warranty period.